

**PULL OUT
CONDENSING UNIT**



**DIGITAL CONTROLLER
WITH HIGH PRESSURE
ALARM**



REAR STORAGE



**PULL OUT EVAP PAN
FOR EASY CLEANING**

DELI CASES

**MEDIUM TEMPERATURE
TILT FORWARD CURVED
TEMPERED FRONT GLASS
REAR TEMPERED SLIDING DOORS
USED FOR DELI AND PACKAGED MEAT**

MODELS

**KPM - CG - (60,80,100) - S
KPM - CG - (60,80,100) - R**



Intertek



Intertek

**SELF CONTAINED OR REMOTE
404A REF - FORCED AIR REFRIGERATION**

**DOE
ENERGY
COMPLIANT**



Tel.: 514.737.9701 / Toll Free: 888.275.4538
Fax: 514.342.3854 / Toll Free: 877.453.8832
sales@mvpgroupcorp.com www.mvpgroupcorp.com

SELF CONTAINED	MODEL	O.A LENGTH INCHES	CASE TEMP	ELECTRICAL - 115 VOLTS					WEIGHT
				COMPRESSOR		LIGHTS AND FANS	EVAP PAN	TOTAL AMPS	
				F.L.A.	L.R.A.				
	KPM-CG-60-S	60	39/41 F	8.4	41	1.6	3.3	13.3	252
	KPM-CG-80-S	77-1/2	39/41 F	8.4	41	1.6	3.3	13.3	536
	KPM-CG-100-S	101-1/8	39/41 F	9.9	49	2.1	3.3	15.6	657

REMOTE	MODEL	O.A LENGTH INCHES	CASE TEMP	115 VOLTS TOTAL AMPS	B.T.U.	WEIGHT
	KPM-CG-60-R	60	39/41 F	1.1	3260	202
	KPM-CG-80-R	77-1/2	39/41 F	1.2	4209	486
	KPM-CG-100-R	101-1/8	39/41 F	1.7	4845	607

THESE CASES ARE DESIGNED TO OPERATE USING R404A REFRIGERANT

B.T.U.'S CALCULATED AT +20° F EVAP AND 90° F AMBIENT

CASES ENGINEERED TO OPERATE AT 75° F AND 55% RH

** ON REMOTE CASES - IF NO FLOOR DRAIN IS PROVIDED -

AN EVAPORATIVE DRAIN PAN MUST BE ORDERED

ADD 3.3 AMPS WHEN USING A PAN

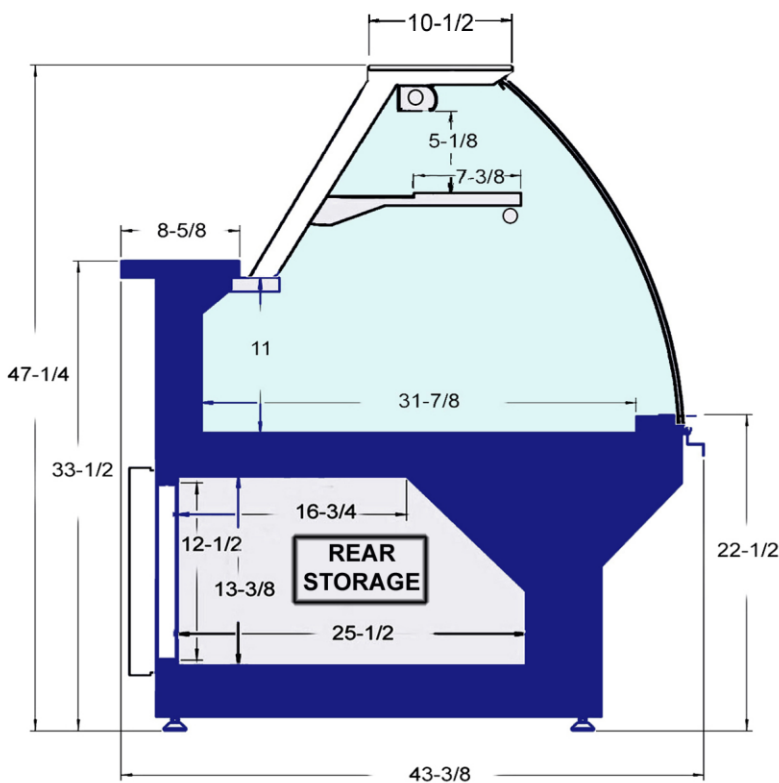

STANDARD FEATURES

- INSULATION - HIGH DENSITY CFC FREE POLYURETHANE FOAM
- INTERIOR - STAINLESS STEEL
- EXTERIOR - PVC COATED STEEL-SILVER
- ENDS-FOAMED BLACK POLYSTYRENE
- TILT- FORWARD TEMPERED CURVED FRONT GLASS
- CORD AND PLUG
- CASES ARE MULTIPLEXIBLE
- TEMPERED GLASS NON- REFRIGERATED SHELF
- LED LIGHTING IN CANOPY AND UNDER SHELF
- REMOVABLE REAR TEMPERED GLASS SLIDING DOORS
- DEFROST AND TEMPERATURE REGULATED BY A DIGITAL CONTROLLER
- HIGH PRESSURE SAFETY ALARM
- PULL- OUT EVAPORATIVE PAN ON SELF- CONTAINED CASES FOR EASY CLEANING
- PULL-OUT CONDENSING UNIT
- ANTI-CONDENSATE SYSTEM FOR FRONT GLASS
- ADJUSTABLE FEET
- ETL LISTED TO UL471 AND SANITATION CLASSIFIED TO NSF7

OPTIONAL FEATURES

- CASTERS - ADD 4-3/8" TO HEIGHT
- ADJUSTABLE STAINLESS STEEL LEGS- FROM 5-1/8" TO 7-5/8"
- OTHER COLORS AVAILABLE
- STAINLESS STEEL EXTERIOR
- EVAPORATIVE PAN FOR REMOTE CASES

WARRANTY

ONE YEAR PARTS AND LABOR WITH FOUR ADDITIONAL YEARS COMPRESSOR (PARTS ONLY)

MOUNTING		
STANDARD	OPTIONAL	OPTIONAL
ADJUSTABLE FEET	ADJUSTABLE LEGS	CASTERS